

DO NOT SCALE

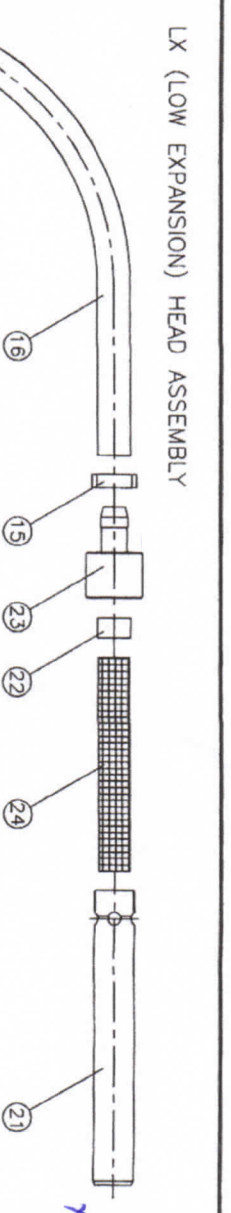
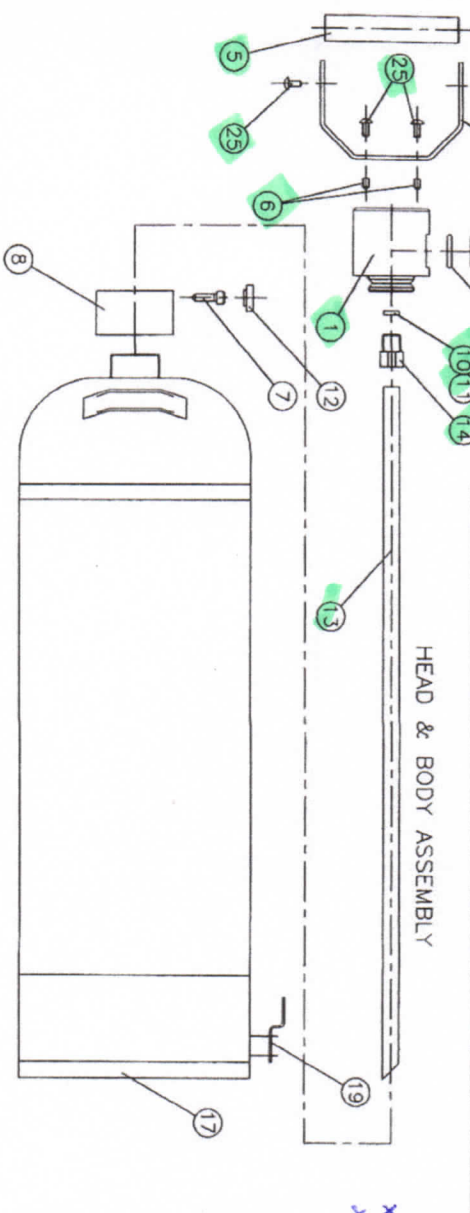
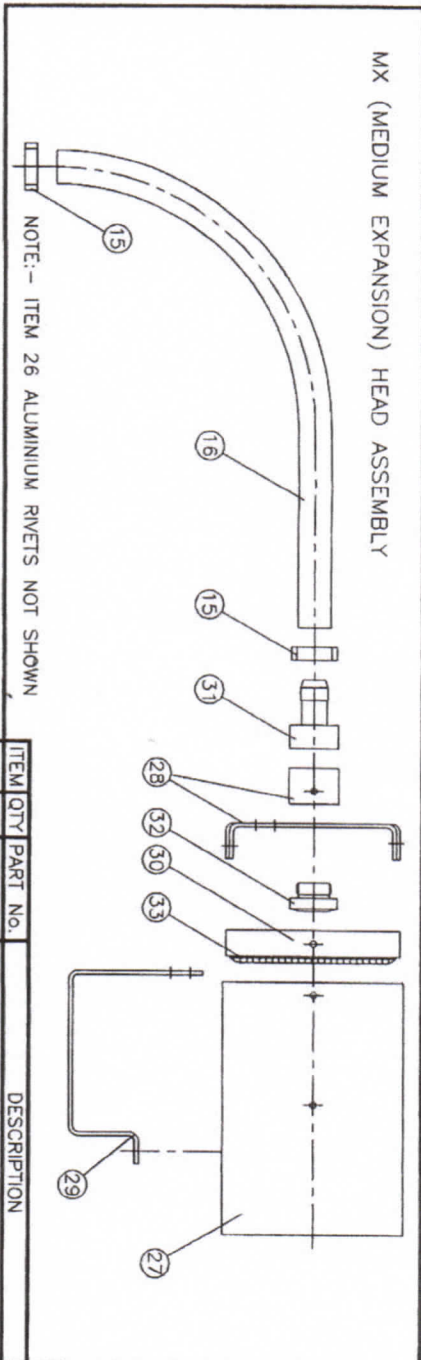

ITEM	QTY	PART No.	DESCRIPTION
1	1	DM-P100	PRIMA MIXER HEAD
2	1	DM-P101	PRIMA INSERT
3	2	DM-P102	O RING (8S 210)
4	1	DM-P103	PRIMA U-HANDLE
5	1	DM-P104	PRIMA HANDLE GRIP
6	2	DM-P105	SET SCREWS (M5 x 8 CONE POINT)
7	1	DM-P106	CONE POINT SCREW
8	1	DM-P107	PRIMA NECK RING
9	1	DM-P108	1" BALL VALVE
10	1	DM-P109	3% ORIFICE
11	1	DM-P110	6% ORIFICE
12	1	DM-P111	M6 BLACK KNURLED KNOB
13	1	DM-P112	PICK-UP STICK
14	1	DM-P113	PICK-UP INSERT
15	2	DM-P114	1 1/16" OETIKER CLIP
16	1	DM-P115	FOAM DELIVERY TUBE
17	1	DM-P116	MAIN BODY
18	1	DM-P117	ADAPTOR 1" x 1 1/2" MALE B.S.P
19	1	DM-P118	BODY CLIP
20	1	DM-P119	STORZ D x 1" B.S.P. MALE ADAPTOR
21	1	DM-P120	LX BRANCH PIPE BODY
22	1	DM-P121	LX CUP INSERT
23	1	DM-P122	LX NOZZLE HOLDER
24	1	DM-P123	STAINLESS STEEL NET INSERT
25	4	DM-P124	M5 x 10 (BUTTON HD SCK SCREW)
26	11	DM-P125	ALUMINIUM RIVETS (4.0 x 9.5)
27	1	DM-P130	MEDIUM EXPANSION TUBE
28	1	DM-P131	TUBE CROSS SECTIONS
29	1	DM-P132	HANDLE
30	1	DM-P133	NET RING
31	1	DM-P134	NOZZLE HOLDER
32	1	DM-P135	MX NOZZLE
33	1	DM-P136	STAINLESS STEEL MESH
34	1	DM-P140	DELTA LABEL
35	2	DM-P141	ALPHAMOUSSE LABELS
36	1	DM-P142	KIDDE THORN LABELS

DELTA FIRE

PRIMA FOAM UNIT
WORKS INSTRUCTION
DRAWING

DATE: 30-03-95
SCALE: 1:4
GRR. BY: G.C.E.

DRG. No. WI-PRIMA
REV. A

8 WISSON ROAD,
RACHEMUN BUSINESS EST. TEL: (0903) 721490
KORIMCHI NH13 GR. FAX: (0903) 721496

1. w. g